

Suite 601 East Memorial - Available

601-609 E Memorial Rd Oklahoma City, OK 73114

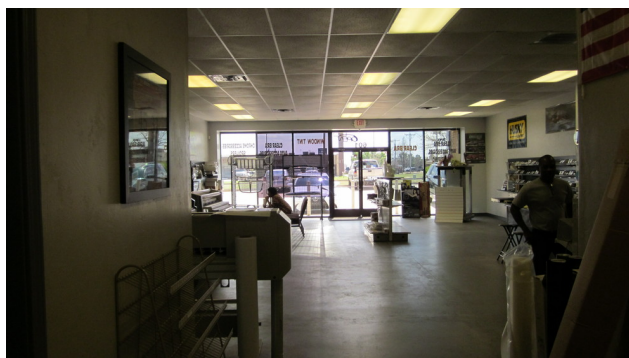

SPACE NOW AVAILABLE

Available SF:	3,000 SF
Lease Rate:	Negotiable
Lot Size:	0.52 Acres
Building Size:	8,000 SF
Zoning:	C-3
Sub Market:	North

This space shares the building with the popular Gellco Clothing & Shoe store.

Easy access to Broadway Extension and Kilpatrick Turnpike - Great visibility to Memorial Rd.

- . Showroom
- . Office
- . Kitchen
- . Warehouse
- . Pylon signage available

FOR MORE INFORMATION, CONTACT

Susan Brinkley
sbrinkley@priceedwards.com
405.239.1244
210 Park Ave, Suite 700
Oklahoma City, OK 73102
www.priceedwards.com

091217

Suite 601 East Memorial - Available

601-609 E Memorial Rd Oklahoma City, OK 73114

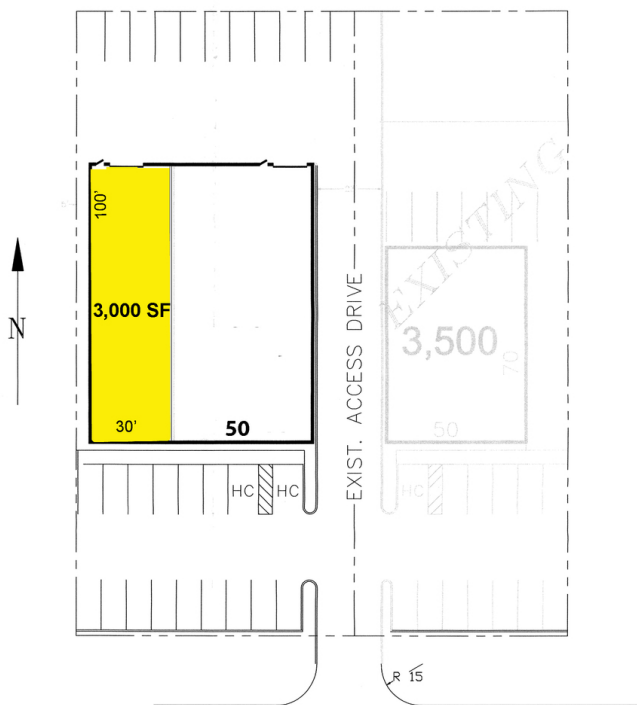

DEMOGRAPHICS (per 2010 Census; 5 Miles Radius)

Total Population	160,248
Population Density	160,248
Median Age	32.8
Median Age (Male)	31.0
Median Age (Female)	34.3
Total Households	64,901
# of Persons Per HH	2.5
Average HH Income	\$71,664
Average House Value	\$189,161

TRAFFIC COUNTS (per ACOG)

Memorial Rd	east	23,637
Memorial Rd	west	19,768